

Mid-America
Sports Advantage
MASA

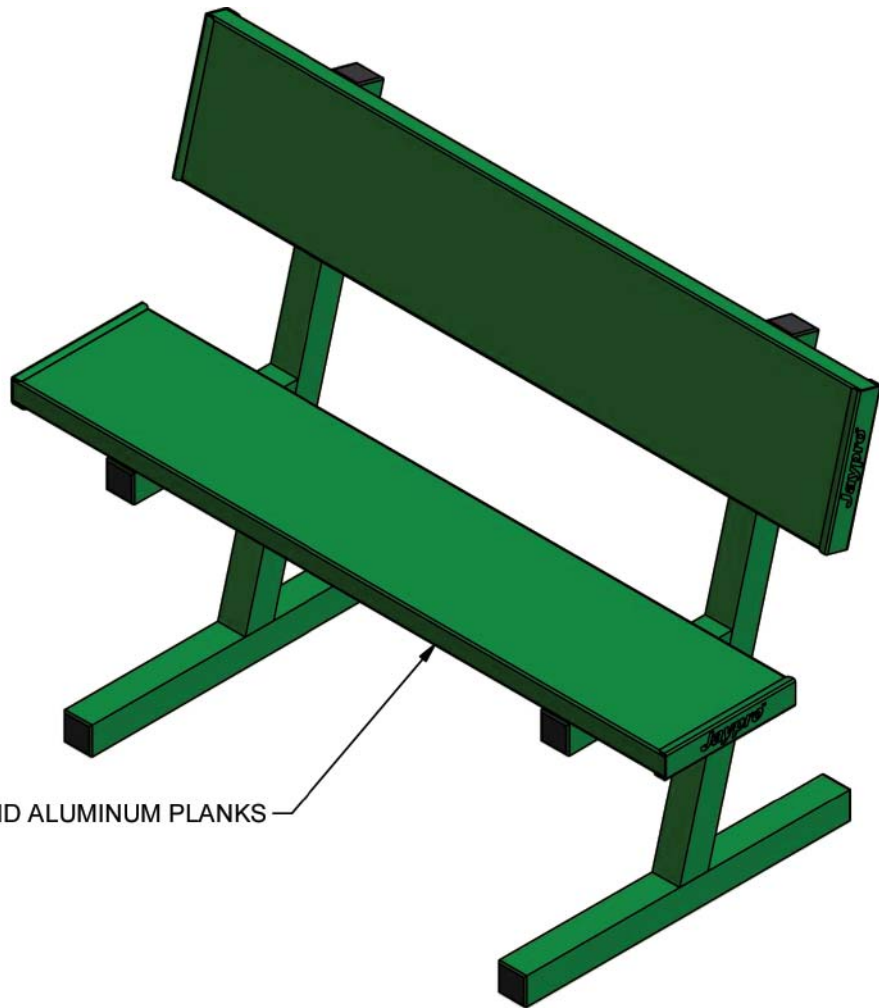

10" WIDE NON-SKID ALUMINUM PLANKS

FEATURES:

- 10" WIDE NON-SKID ALUMINUM PLANKS
- 2" x 2" HEAVY DUTY GALVANIZED STEEL LEGS FOR SUPERIOR RUST RESISTANCE
- PLANKS ARE SUPPORTED BY A STRONG, GALVANIZED STEEL UNDERSTRUCTURE
- PLAYER BENCH WITH SEAT BACK
- SEAT PLANK IS 18" FROM GROUND
- FLOOR PROTECTION KIT AVAILABLE FOR INDOOR USE

OPTIONS:

- CUSTOM POWDER COATED COLORS
- OPTIONAL FLOOR PROTECTOR KIT (PSS-4FT)

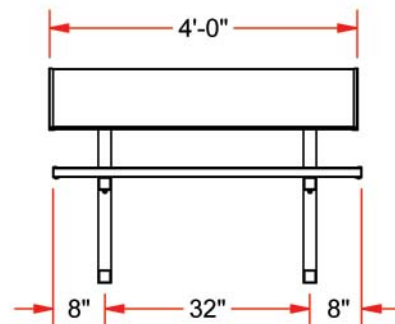
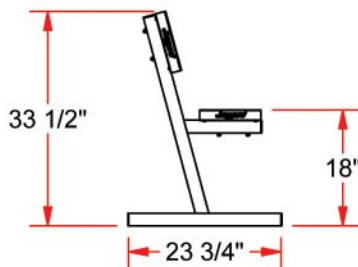

Mid-America
Sports Advantage
MASA

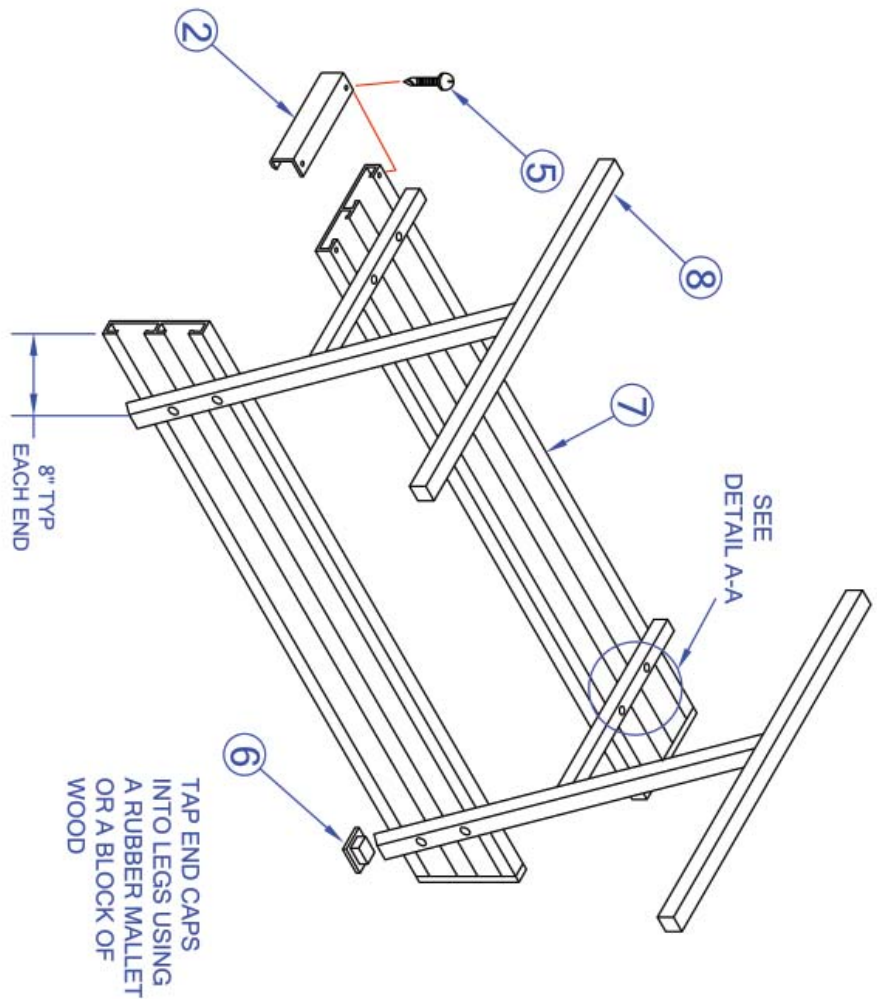
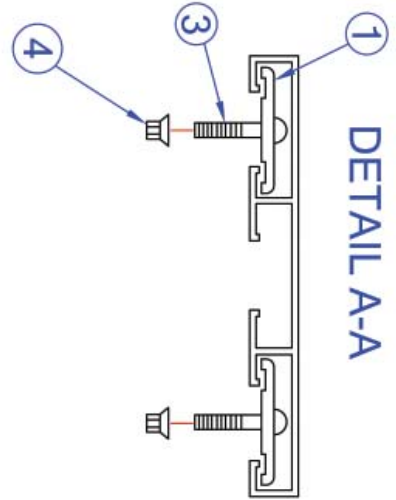

- PLEASE NOTE:
- 1) FOR SAFE OPERATION AND CONTINUED HIGH PERFORMANCE FROM THIS EQUIPMENT, INSPECTION AND MAINTENANCE MUST BE PERFORMED BEFORE EACH USE
 - 2) USE OF THIS EQUIPMENT OTHER THAN INTENDED, MAY BE HAZARDOUS.
 - 3) ALTERATION OR MODIFICATION OF EQUIPMENT MAY BE HAZARDOUS. FOR REPAIR OR REPLACEMENT, PLEASE CALL YOUR DEALER



4' PLAYER'S BENCH WITH BACK REST

LIST OF MATERIALS

<u>PIECE NO.</u>	<u>PART NO.</u>	<u>DESCRIPTION</u>	<u>QTY.</u>
1	AR5044	Bolt Clip With Slot	8
2	AR5045	End Cap	4
3	HB5030	Carriage Bolt 5/16"-18 X 3"	8
4	HN5046	5/16" Flange Nut	8
5	HS5035	#8 Pan Head Screw x 1/2"	8
6	EP0018	2" End Cap	8
7	AR5087	4 Ft Seat Plank	2
8	PB801	Leg	2

ASSEMBLY INSTRUCTIONS

TOOLS REQUIRED: Phillips Screwdriver Bit With Electric Drill (1),
1/2" Socket Wrench Or Adjustable Wrench (1)

- 1) Slip the end caps (2) snugly onto each end of the plank (7). Using the electric drill, assemble a self-drilling screw (5) through the cap and into the flange of the plank. Two screws are required per end cap. Carefully assemble 2" end caps (6) into bench legs (8).
- 2) For easiest assembly, position seat plank (7) on a level raised surface such as a desk top, bleacher seat or work bench. Place the carriage bolt (3) and bolt clips (1) approximately into place within the slots of the plank. Note that the legs should be no more than 8" from the plank edge.
- 3) ,Position the legs as shown and loosely assemble the hardware illustrated in detail 'A-A'. Do not fully tighten the hardware at this time.
- 4) Stand the unit upright and assemble the backrest plank (7) as illustrated. Level the bench and make sure the legs are adequately spaced apart. Tighten all fasteners fully.